

REVISIONS				
REV	DATE	DESCRIPTION	CHG	APPR

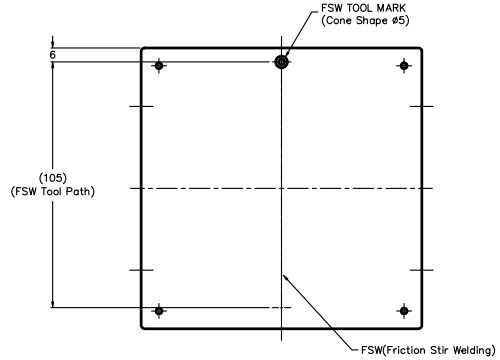
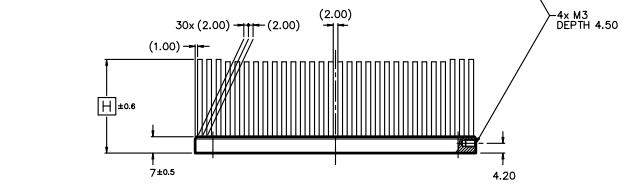
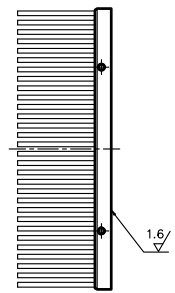
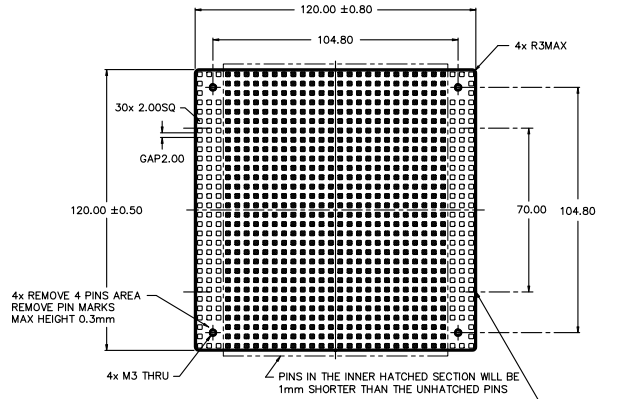

- NOTES : UNLESS OTHERWISE SPECIFIED
1. INTERPRET DIMENSIONS AND TOLERANCES PER ANSI Y14.5M
  2. ALL DIMENSIONS ARE IN MILLIMETERS
  3. MATERIAL : ALUMINUM 6063
  4. FINISH : CLEAR ANODIZE
  5. TOLERANCES :
    - .XX ±0.254
    - .XXX ±0.127
    - ANGLES ± 1°
  6. REMOVE ALL BURRS AND BREAK SHARP EDGES. UNSPECIFIED CORNER R0.5 MAX OR C0.5 MAX
  7. ALLOWABLE FIN BENDING: FINs CANNOT BE IN CONTACT.
  8. SLIGHT DEFORMATION AND UNEVEN SURFACE FINISH IN THE AREA SURROUNDING THE FSW JOINT IS PERMISSIBLE. FIN HEIGHT IN JOINT AREA CAN BE 0.50mm TALLER THAN STANDARD TOLERANCE LIMITS.
  9. BASED ON ALPHA STANDARD HEAT SINK S2012080 SERIES.

FSI2025A	25.00	<b>S001ZP1Z</b>		
FSI2040A	40.00	<b>S001ZP20</b>		
MODEL NO.	HEIGHT	PART NO.	REMARK	
	□			
<b>ALPHA CO.LTD.</b>		CSTM'S PART NO.		
		MATERIAL	NAME	
SCALE	APPR & CHCK	PART NO. & DWG NO.		REV
1 : 1	N. MIZUKOSHI	S001ZP1Y		
DATE	DSGN & DWG	RDCTN:		LOFF:
MAR 11, 2024	N. MIZUKOSHI			