

**SR Series**  
**Omnidirectional Heat Sink**  
**with Mounting Tabs**

**ALPHA**

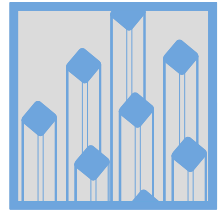

### DIM

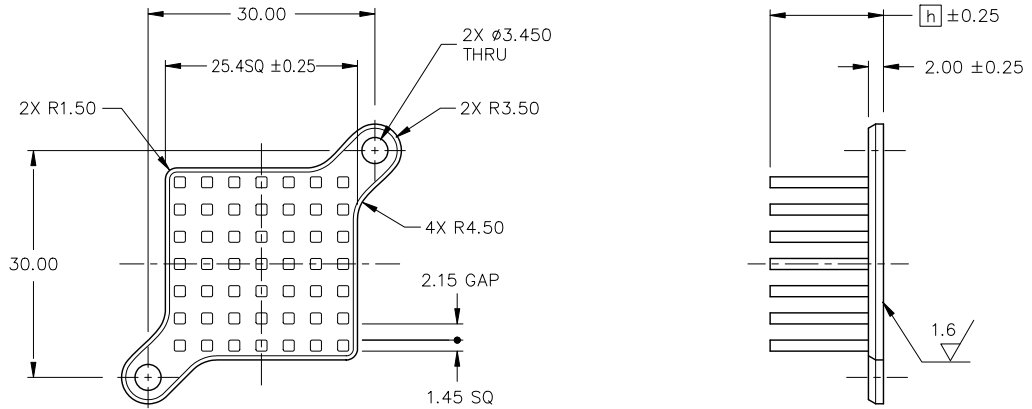

MODEL	HEATSINK HEIGHT $h$	WEIGHT (grams)
SR25-8B	8	5.6
SR25-10B	10	6.1
SR25-12B	12	6.7
SR25-15B	15	7.5
SR25-20B	20	8.9
SR25-20B	25	10.2

MATERIAL : A6063  
 FINISH : BLACK ANODIZE  
 DIMENSIONS : mm

### DATA

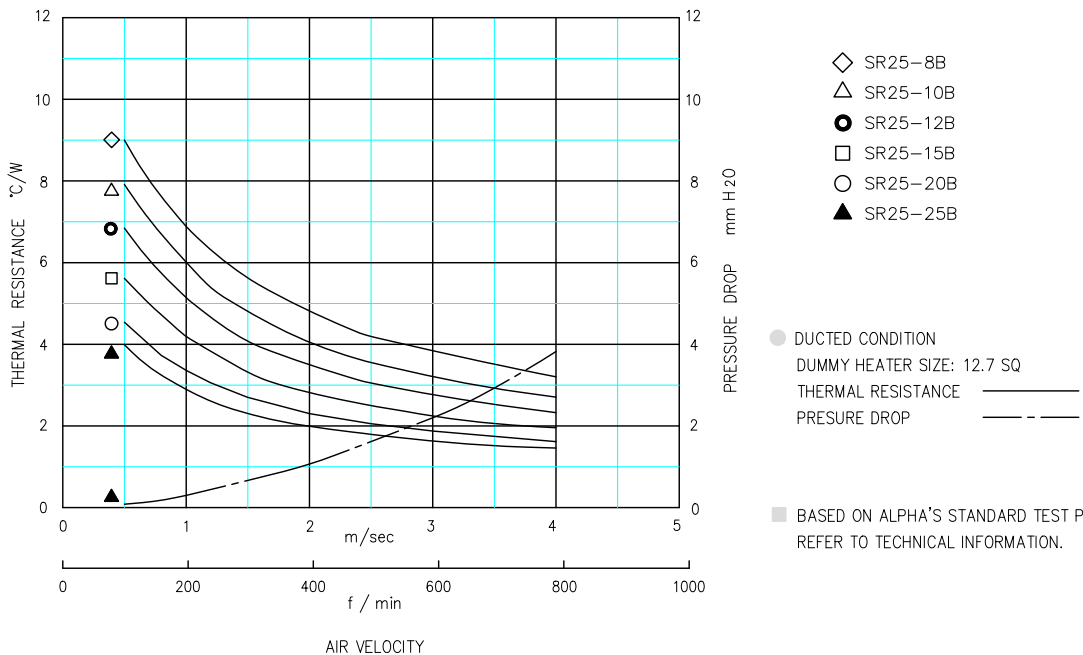

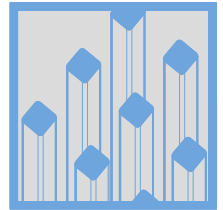

### DIM

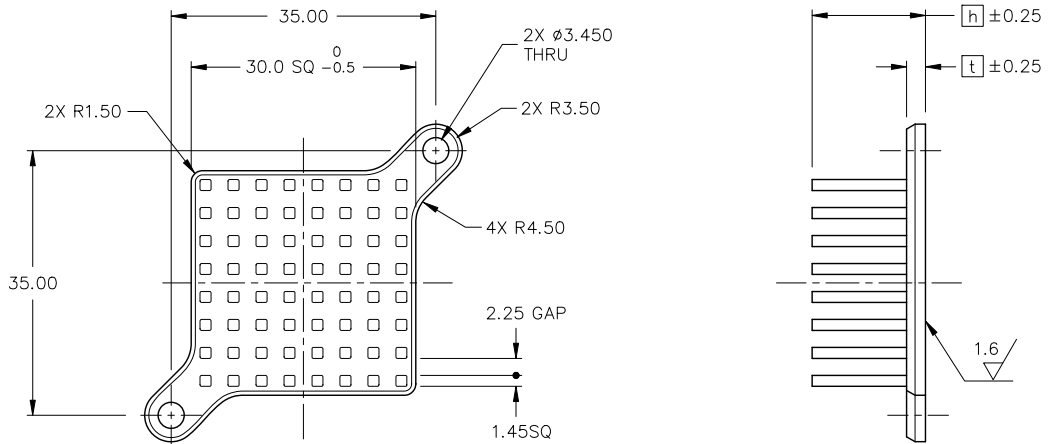

MODEL	HEIGHT [h]	THICKNESS [h]	WEIGHT (grams)
SR30-8B	8	2.50	7.4
SR30-10B	10		9.3
SR30-12B	12		10.0
SR30-15B	15		11.1
SR30-20B	20		12.8
SR30-25B	25		14.6
SR30-[h]B	$h < 10$	2.00	-
	$10 \leq h$	2.50	-

MATERIAL : A6063  
 FINISH : BLACK ANODIZE  
 DIMENSIONS : mm

### DATA

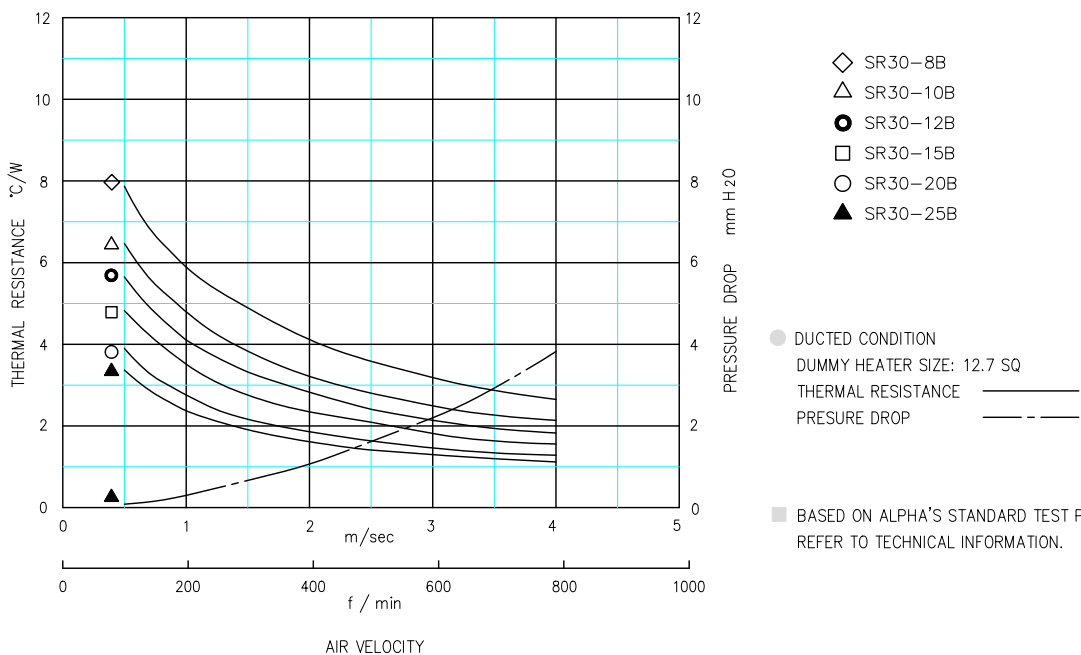

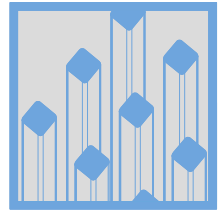

### DIM

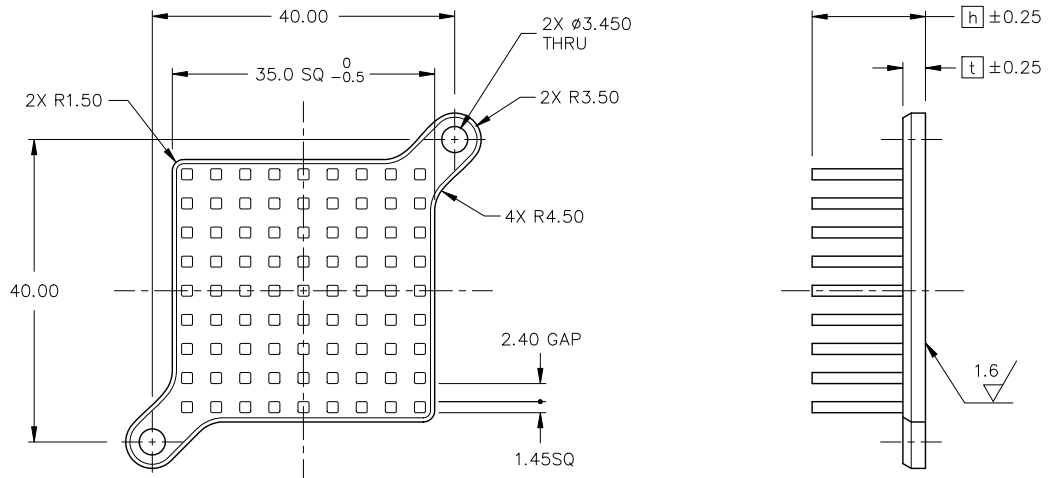

MODEL	HEIGHT [h]	THICKNESS [h]	WEIGHT (grams)
SR35-8B	8	3.00	9.7
SR35-10B	10		13.7
SR35-12B	12		14.6
SR35-15B	15		15.9
SR35-20B	20		18.2
SR35-25B	25		20.5
SR35-[h]B	$h < 10$	2.00	-
	$10 \leq h$	3.00	-

MATERIAL : A6063  
 FINISH : BLACK ANODIZE  
 DIMENSIONS : mm

### DATA

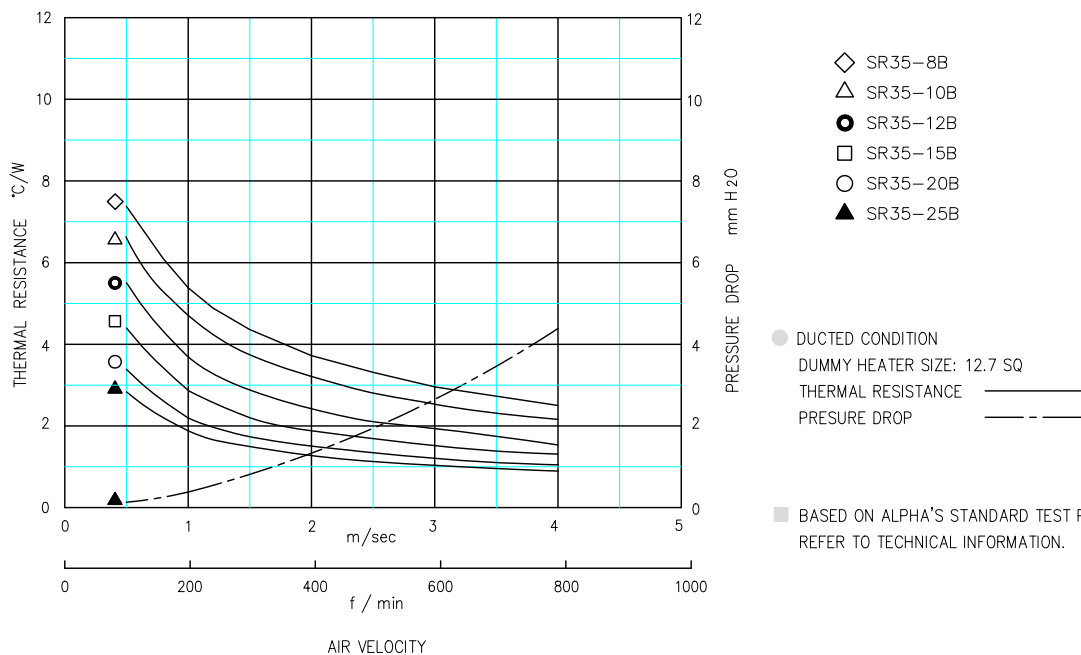

● DUCTED CONDITION  
 DUMMY HEATER SIZE: 12.7 SQ  
 THERMAL RESISTANCE ———  
 PRESURE DROP - - - -

■ BASED ON ALPHA'S STANDARD TEST PROCEDURE.  
 REFER TO TECHNICAL INFORMATION.

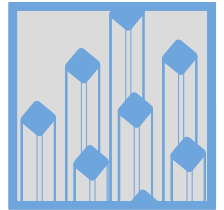

### DIM

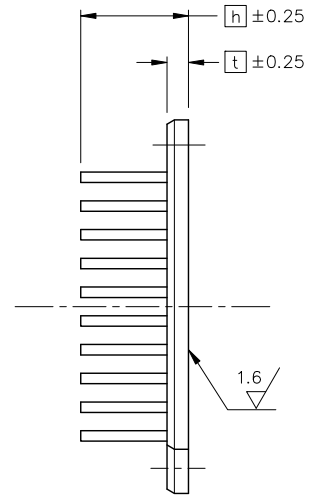
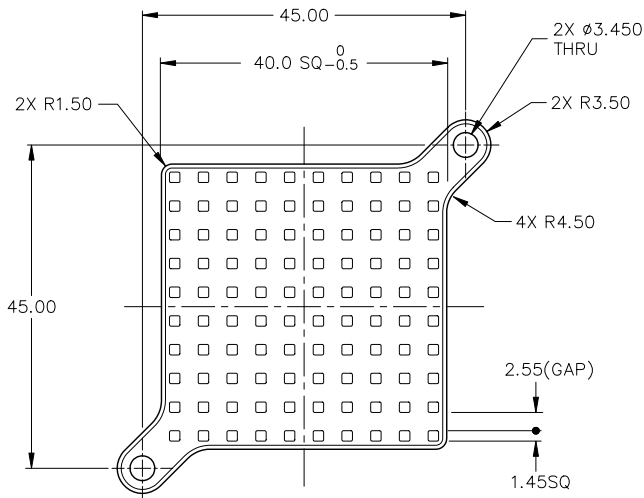

MODEL	HEIGHT [h]	THICKNESS [h]	WEIGHT (grams)
SR40-8B	8	2.50	14.3
SR40-10B	10	3.00	17.4
SR40-12B	12		18.5
SR40-15B	15		20.2
SR40-20B	20		23.0
SR40-25B	25		25.8
SR40-[h]B	[h] < 10	2.50	-
	10 ≤ [h]	3.00	-

MATERIAL : A6063  
 FINISH : BLACK ANODIZE  
 DIMENSIONS : mm

### DATA

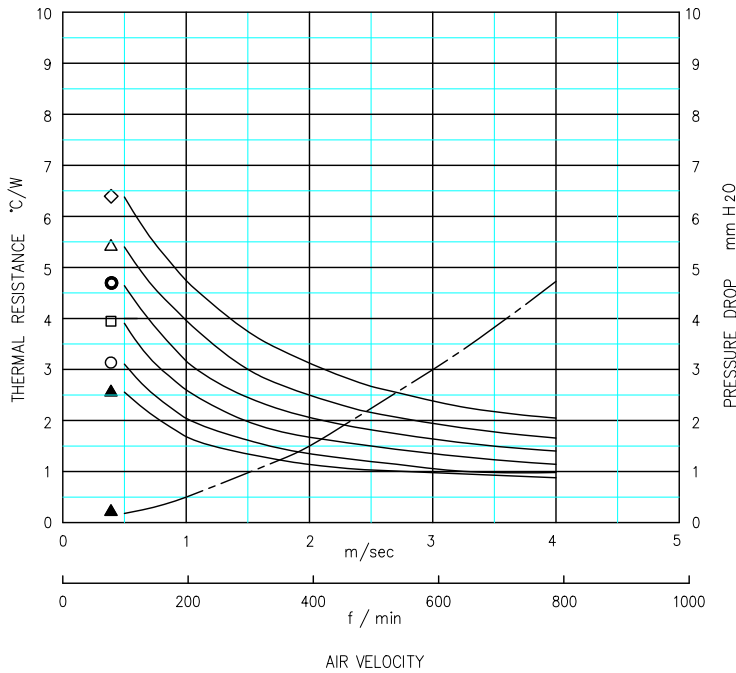

- ◇ SR40-8B
- △ SR40-10B
- SR40-12B
- SR40-15B
- SR40-20B
- ▲ SR40-25B

● DUCTED CONDITION  
 DUMMY HEATER SIZE: 12.7 SQ  
 THERMAL RESISTANCE ———  
 PRESURE DROP - - - - -

■ BASED ON ALPHA'S STANDARD TEST PROCEDURE.  
 REFER TO TECHNICAL INFORMATION.

REF



PCB HOLE LAYOUT

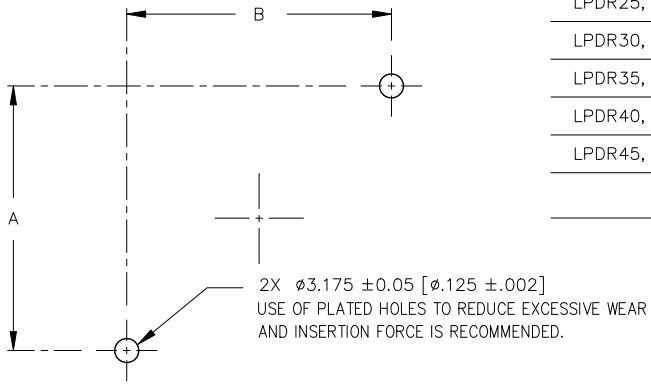

LPDR19 AND UBR19	22.0	22.0
LPDR25, UBR25, NR25 AND SR25	30.0	30.0
LPDR30, UBR30, NR30 AND SR30	35.0	35.0
LPDR35, UBR35, NR35 AND SR35	40.0	40.0
LPDR40, UBR40, NR40 AND SR40	45.0	45.0
LPDR45, UBR45 AND NR45	50.0	50.0
MODEL	A	B